



Uputstvo za upotrebu

Nadgradna LED strela sa prekidačem

4058075106093 **Linear Compact SWITCH 300 4W/4000K**, 4058075106079 **Linear Compact SWITCH 300 4W/3000K**
 4058075106116 **Linear Compact SWITCH 600 8W/3000K**, 4058075106130 **Linear Compact SWITCH 600 8W/4000K**
 4058075106192 **Linear Compact SWITCH 900 12W/3000K**, 4058075106215 **Linear Compact SWITCH 900 12W/4000K**
 4058075106178 **Linear Compact SWITCH 1200 14W/4000K**, 4058075106154 **Linear Compact SWITCH 1200 14W/3000K**

Nakon što proizvod izvadite iz ambalaže proverite da li se oštetio u toku transporta.

MONTAŽA

Montažu smeju da vrše samo stručna lica pridržavajući se aktuelnih propisa i mera zaštite! Pre montaže LED lampe, treba da izbušite rupe za tiplje. U rupe za nosače postavite tiplje i fiksirajte nosače LED lampe. Montaža se sme raditi samo na površine odgovarajuće nosivosti. Prema potrebi koristite tiplje i šarafe pogodne za površinu na koju želite montirati lampu. Prilikom povezivanja naponskog kabela vodite računa da je struja isključena! Sada možete da montirate LED nadgradnu lampu na nosače.

NAPOMENA: naponski kabel treba da se postavi u utikač na lampi.

SPAJANJE LAMPI

Ovu lampu možete spojnicom ili sa kablom da povežete sa više lampi i stvorite niz (ovo je moguće samo sa modelom lampe iste serije). U tom slučaju one koriste isti (jedan) izvor napajanja. Na prvu lampu u nizu treba da priključite naponski kabel (naponski kabel se postavlja u utikač).

NAPOMENA: maksimalan broj spojenih lampi (niza) ne sme da bude više od 10 kom.

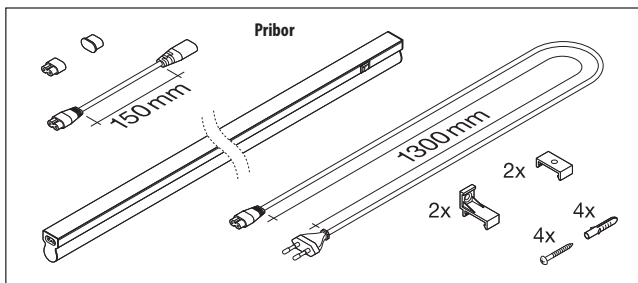

TEHNIČKI PODACI

Model: 4058075106093 Linear Compact SWITCH 300 4W/4000K

Napajanje: 220-240V~; Snaga: 4 W; Struja: 32 mA
 Temperatura svetlosti: 4000 K; Jačina svetlosti: 450lm; Tip diode: SMD; Ugao osvetljenja: 140°
 Faktor snage: >0.5; CRI vrednost: > 80 Ra; Vreme zagrevanja: <0.5 s; Potrošnja: 4 kWh / 1000 h; Radni vek: 50000 h; Broj uklj. / isklj.: 100000 Dimabilnost: Ne; Materijal kućišta: Plastika Boja kućišta: Bela; IP zaštita: IP20; Prekidač: Da Radna temperatura: -20 do +40°C; Dimenzije: 313.0 x 28.0 x 36.0 mm

Model: 4058075106079 Linear Compact SWITCH 300 4W/3000K

Napajanje: 220-240V~; Snaga: 4 W; Struja: 32 mA
 Temperatura svetlosti: 3000 K; Jačina svetlosti: 400lm; Tip diode: SMD; Ugao osvetljenja: 140°
 Faktor snage: >0.5; CRI vrednost: > 80 Ra; Vreme zagrevanja: <0.5 s; Potrošnja: 4 kWh / 1000 h; Radni vek: 50000 h; Broj uklj. / isklj.: 100000 Dimabilnost: Ne; Materijal kućišta: Plastika Boja kućišta: Bela; IP zaštita: IP20; Prekidač: Da Radna temperatura: -20 do +40°C; Dimenzije: 313.0 x 28.0 x 36.0 mm

Model: 4058075106116 Linear Compact SWITCH 600 8W/3000K

Napajanje: 220-240V~; Snaga: 8 W; Struja: 62 mA
 Temperatura svetlosti: 3000 K; Jačina svetlosti: 800lm; Tip diode: SMD; Ugao osvetljenja: 140°
 Faktor snage: >0.5; CRI vrednost: > 80 Ra; Vreme zagrevanja: <0.5 s; Potrošnja: 8 kWh / 1000 h; Radni vek: 50000 h; Broj uklj. / isklj.: 100000 Dimabilnost: Ne; Materijal kućišta: Plastika Boja kućišta: Bela; IP zaštita: IP20; Prekidač: Da Radna temperatura: -20 do +40°C; Dimenzije: 573.0 x 28.0 x 36.0 mm

Model: 4058075106130 Linear Compact SWITCH 600 8W/4000K

Napajanje: 220-240V~; Snaga: 8 W; Struja: 62 mA
 Temperatura svetlosti: 4000 K; Jačina svetlosti: 800lm; Tip diode: SMD; Ugao osvetljenja: 140°
 Faktor snage: >0.5; CRI vrednost: > 80 Ra; Vreme zagrevanja: <0.5 s; Potrošnja: 8 kWh / 1000 h; Radni vek: 50000 h; Broj uklj. / isklj.: 100000 Dimabilnost: Ne; Materijal kućišta: Plastika Boja kućišta: Bela; IP zaštita: IP20; Prekidač: Da Radna temperatura: -20 do +40°C; Dimenzije: 573.0 x 28.0 x 36.0 mm

1 Izmerite dužinu

	d
LINEAR COMPACT SWITCH 300	290 mm
LINEAR COMPACT SWITCH/HO 600	550 mm
LINEAR COMPACT SWITCH/HO 900	850 mm
LINEAR COMPACT SWITCH/HO 1200	1150 mm
LINEAR COMPACT HO 1500	1450 mm

2 Izbušite rupe

3a Montirajte nosače

3b Montirajte nosače

Razdaljina do najbližeg predmeta koji se osvetljava!



Nakon isteka radnog veka ovog proizvoda, proizvod ne bacajte sa otpadom iz domaćinstva. Elektronski otpad se predaje u reciklažne centre tog tipa. Ovim postupkom štitite okolinu, vaše zdravlje i zdravlje ostalih. U reciklažnim centrima se informišite u prodavnici gde ste ovaj proizvod kupili.



Opasnost od strujnog udara! Zabranjeno rastavljati uređaj i njegove delove prepravljati! U slučaju bilo kojeg kvara ili oštećenja, odmah isključite uređaj i obratite se stručnom licu!



LED nadgradna lampica nije dimabilna

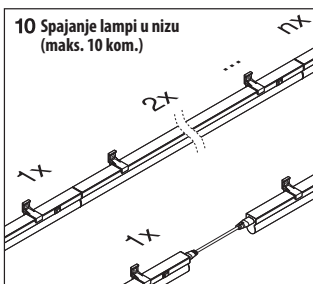
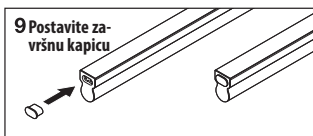
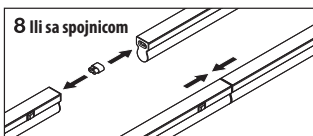
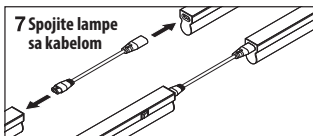
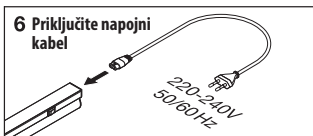
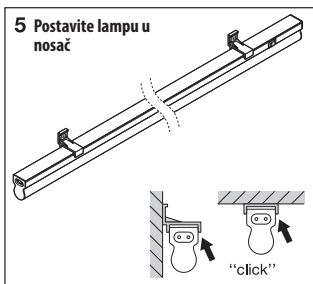
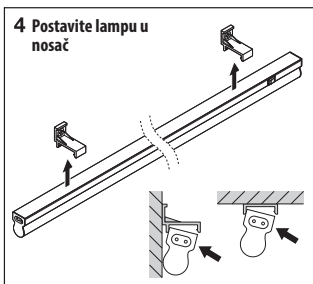

	n
LINEAR COMPACT SWITCH 300	10
LINEAR COMPACT SWITCH/HO 600	10
LINEAR COMPACT SWITCH/HO 900	10
LINEAR COMPACT SWITCH/HO 1200	10
LINEAR COMPACT HO 1500	10

NAPOMENE

- Pridržavajte se ovog uputstva za upotrebu.
- Pre povezivanja se uverite da se proizvod nije ošteti u toku transporta!
- Ukoliko je proizvod oštećen, nemojte ga koristiti.
- Instalacije i popravke prepuštite stručnom licu.
- Sa pažnjom se ophodite prema ovom proizvodu.
- Bilo kakva povezivanja i podešavanja radite samo dok je lampa isključena!
- Uverite se da sistem nije pod naponom pre instalacije.
- Obavezno je korišćenje u okviru deklarisanog napona.
- Proverite instalaciju pre uključivanja napona!
- Zabranjeno prekrivati u toku rada, zabranjeno uključivati dok je u ambalaži!
- LED izvor svetlosti nije zamenljiv!
- Upotrebljivo samo u suvim zatvorenim prostorijama!
- Ne gledajte direktno u svetlost LED diode i ne usmeravajte je na druga lica!
- Lampa nije dimabilna.
- Blago zagrevanje u toku rada je normalna pojava. Prilikom montaže treba ostaviti dovoljno prostora za ventilaciju!
- U slučaju bilo kakvog oštećenja odmah isključite napajanje, i obratite se stručnom licu!
- Lampu je zabranjeno rastavljati i prepravljati, zbog opasnosti od strujnog udara. Pri radu treba se pridržavati standardnih mera zaštite!
- Kvarovi prouzrokovani nestručnim, nepravilnim povezivanjem i nestručnim rukovanjem ne spadaju pod garanciju!
- Lampu štite od direktne toplote, sunca, prašine, vlage, i tečnosti!
- Štitite je od fizikih oštećenja!
- Radi optimalnog rada, u zavisnosti od količine prljavštine, LED lampu treba povremeno očistiti.
- Pre čišćenja isključite LED lampu.
- Ostavite da se ohladi (min. 10-15 minuta).
- Čišćenje vršite mekanim krpama. Ne koristite agresivna hemijska sredstva.
- Lampa se sme čistiti isključivo suvom krpom!
- Lampu štite od ekstremnih uslova rada, direktne toplote, sunca, prašine, pare i udara!

Model: 4058075106192 Linear Compact SWITCH 900 12W/3000K

Napajanje: 220-240V~; Snaga: 12 W; Struja: 83 mA Temperatura svetlosti: 3000 K; Jačina svetlosti: 1200lm; Tip diode: SMD; Ugao osvetljenja: 140° Faktor snage: >0.5; CRI vrednost: > 80 Ra; Vreme zagrevanja: <0.5 s; Potrošnja: 12 kWh / 1000 h; Radni vek: 50000 h; Broj uklj. / isklj.: 100000 Dimabilnost : Ne; Materijal kućišta: Plastika Boja kućišta: Bela; IP zaštita: IP20; Prekidač: Da Radna temperatura: -20 do +40°C; Dimenzije: 873.0 x 28.0 x 36.0 mm

Model: 4058075106178 Linear Compact SWITCH 1200 14W/4000K

Napajanje: 220-240V~; Snaga: 14 W; Struja: 100 mA Temperatura svetlosti: 4000 K; Jačina svetlosti: 1500lm; Tip diode: SMD; Ugao osvetljenja: 140° Faktor snage: >0.5; CRI vrednost: > 80 Ra; Vreme zagrevanja: <0.5 s; Potrošnja: 14 kWh / 1000 h; Radni vek: 50000 h; Broj uklj. / isklj.: 100000 Dimabilnost : Ne; Materijal kućišta: Plastika Boja kućišta: Bela; IP zaštita: IP20; Prekidač: Da Radna temperatura: -20 do +40°C; Dimenzije: 1173 x 28.0 x 36.0 mm

Model: 4058075106215 Linear Compact SWITCH 900 12W/4000K

Napajanje: 220-240V~; Snaga: 12 W; Struja: 83 mA Temperatura svetlosti: 4000 K; Jačina svetlosti: 1200lm; Tip diode: SMD; Ugao osvetljenja: 140° Faktor snage: >0.5; CRI vrednost: > 80 Ra; Vreme zagrevanja: <0.5 s; Potrošnja: 12 kWh / 1000 h; Radni vek: 50000 h; Broj uklj. / isklj.: 100000 Dimabilnost : Ne; Materijal kućišta: Plastika Boja kućišta: Bela; IP zaštita: IP20; Prekidač: Da Radna temperatura: -20 do +40°C; Dimenzije: 873.0 x 28.0 x 36.0 mm

Model: 4058075106154 Linear Compact SWITCH 1200 14W/3000K

Napajanje: 220-240V~; Snaga: 14 W; Struja: 100 mA Temperatura svetlosti: 3000 K; Jačina svetlosti: 1400lm; Tip diode: SMD; Ugao osvetljenja: 140° Faktor snage: >0.5; CRI vrednost: > 80 Ra; Vreme zagrevanja: <0.5 s; Potrošnja: 14 kWh / 1000 h; Radni vek: 50000 h; Broj uklj. / isklj.: 100000 Dimabilnost : Ne; Materijal kućišta: Plastika Boja kućišta: Bela; IP zaštita: IP20; Prekidač: Da Radna temperatura: -20 do +40°C; Dimenzije: 1173 x 28.0 x 36.0 mm

Oznaka:

4058075106093 Linear Compact SWITCH 300 4W/4000K, 4058075106079 Linear Compact SWITCH 300 4W/3000K
 4058075106116 Linear Compact SWITCH 600 8W/3000K, 4058075106130 Linear Compact SWITCH 600 8W/4000K
 4058075106192 Linear Compact SWITCH 900 12W/3000K, 4058075106215 Linear Compact SWITCH 900 12W/4000K
 4058075106178 Linear Compact SWITCH 1200 14W/4000K, 4058075106154 Linear Compact SWITCH 1200 14W/3000K

Proizvođač: LEDVANCE Lighting Co, Ltd;

Zemlja porekla: Kina

Uvoznik za Srbiju: Reflekta Doo; Srbija, Novi Sad, Rumenačka 23

Telefon: 021/63-61-705; reflektadoo@gmail.com

PRODUCT DATASHEET

LN COMP SWITCH 900 12 W 4000 K

LINEAR COMPACT SWITCH | Compact single or light line luminaire with switch



Areas of application

- Direct replacement for luminaires with fluorescent lamps
- Indoor applications
- Corridors, entrance areas, stairwells, living rooms, basements
- Accent lighting
- Public areas
- Cove lighting
- Shelves, furniture integration or under cabinet mounting
- Seamless linear lighting

Product benefits

- Compact dimensions
- Little space required thanks to compact dimensions
- Seamless connection of up to 10 luminaires in a line
- Handy switch directly installed on the luminaire
- Low flicker light thanks to special electronic control gear
- Flexible installation in 2 different angles with 2 different mounting options
- Flexible application due to a wide range of available lengths of 300 to 1500 mm.
- Angled connection possible with included cable

Product features

- Built-in switch
- Up to 10 luminaires connectable



- Translucent end caps
- Versions with luminous flux 400...1900 lm available
- 5 different lengths available
- High luminous efficacy: up to 112 lm/W
- Glow Wire Test according to IEC 60695-2-12: 850 °C

TECHNICAL DATA

Electrical data

Nominal wattage	12.00 W
Nominal voltage	220...240 V
Mains frequency	50...60 Hz
Nominal current	0.08 A
Inrush current	15 A
Inrush current time T_{h50}	150 μ s
Max. no. of lum. on circuit break. B16 A	40
Max. no. of lum. on circuit break. C10 A	32
Max. no. of lum. on circuit break. C16 A	51
Power factor λ	> 0.5
Total harmonic distortion	89 %
Protection class	II
Operating mode	Integrated LED driver

Photometrical data

Luminous flux	1200 lm
Luminous efficacy	100 lm/W
Color temperature	4000 K
Light color (designation)	Cool White
Color rendering index Ra	> 80
Standard deviation of color matching	< 5 sdcM
Low flicker	Yes
Photobiological safety group acc. to EN62778	RG0
Beam angle	140 °

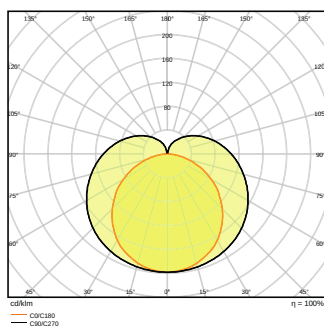

Dimensions & Weight

Length	873.00 mm
Width	28.00 mm
Height	36.00 mm
Product weight	300.00 g

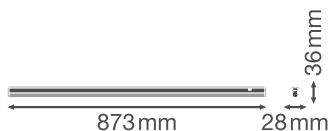

Materials & Colors

Product color	White
Housing color	White
Body material	Polycarbonate (PC)
Cover material	Polycarbonate (PC)
Light emitting surface material	Polycarbonate (PC)
Glow Wire Test according to IEC 60695-2-12	850 °C
Mercury content	0.0 mg

Application & Mounting

Ambient temperature range	-20...+40 °C
Type of connection	Screw terminal, 2-Pole (L,N)
Type of protection	IP20
Protection class IK (shock resistance)	IK03
Dimmable	No
Mounting type	Surface
Mounting location	Ceiling / Wall
LED module replaceable	Not replaceable

Lifespan

Lifespan L70/B50 at 25 °C	50000 h
Lifespan L80/B10 at 25 °C	40000 h
Lifespan L90/B10 at 25 °C	30000 h

Number of switching cycles	100000
----------------------------	--------













Certificates & Standards

Standards	CE / CB / TÜV SÜD / EAC
Luminaire with limited surface temperature, "D sign"	No
Ball shot safe	No

EQUIPMENT / ACCESSORIES

- Equipped with power plug, cable connector and line adapter for connecting further luminaires
- Mounting material for wall and ceiling installations included

DOWNLOAD DATA

DOWNLOAD DATA	
	User instruction LINEAR COMPACT SWITCH/HIGH OUTPUT
	User instruction UI_Linear_Compact_Switch
	Tender documents Tender Text 4058075106215
	Declarations of conformity EU Declaration of Conformity Linear Comp Switch and HO LEDV
	Declarations of conformity Attestation of Conformity Linear Comp
	On-Pack-Info Legal Insert Linear Compact
	IES file (IES) LN COMP SWITCH 900 12W 4000K 230V IP20
	LDT file (Eulumdat) LN COMP SWITCH 900 12W 4000K 230V IP20
	R3D file (Relux 3D Model) Linear Compact Batten 900
	M3D file (3D Model) Linear_Compact_Batten_900
	ULD file (DIALux) LINEARCOMPACTSWITCH90012W4000K
	UGR file (UGR table) LN COMP SWITCH 900 12W 4000K 230V IP20

LOGISTICAL DATA

Product code	Packaging unit (Pieces/Unit)	Dimensions (length x width x height)	Gross weight	Volume
4058075106215	Folding box 1	44 mm x 34 mm x 1,086 mm	386.00 g	1.62 dm ³
4058075106222	Shipping box 25	1,095 mm x 228 mm x 175 mm	10000.00 g	43.69 dm ³

The mentioned product code describes the smallest quantity unit which can be ordered. One shipping unit can contain one or more single products. When placing an order, for the quantity please enter single or multiples of a shipping unit.

ADDITIONAL CATALOG INFORMATION

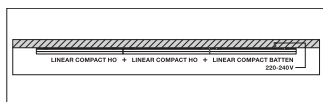
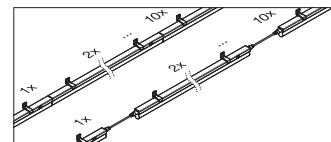
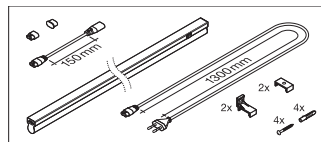
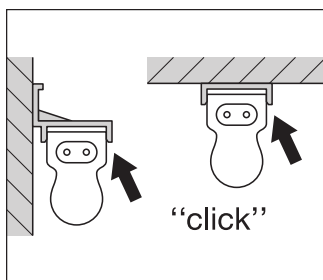

References / Links

- For Guarantee see www.ledvance.com/guarantee

DISCLAIMER

Subject to change without notice. Errors and omission excepted. Always make sure to use the most recent release.